

B U I L D I N G O N T H

The Trustees, Faculty, Staff & Students of Southern Utah University request the honor of your presence at the annual Founders' Day Celebration where the SUU Community will dedicate three magnificent structures:

OLD MAIN • THE CARTER CARILLON

THE EMMA ECCLES JONES TEACHER EDUCATION BUILDING



OLD MAIN

E F O U N D E R S ,

D R E A M S

FRIDAY, MARCH 14, 2008

Dedication Celebration

1:30 p.m. • *Randall*

Jones Theater

DISTINGUISHED

SERVICE HONOREES

Bernice Gillins

York & Evelyn Jones

Morris A. Shirts

Georgia Beth Thompson

Founders' Day Reception

5:00 p.m. • *Whiting*

Room, Haze Hunter

Conference Center

Founders' Day Banquet

5:30 p.m. • *Great Hall*

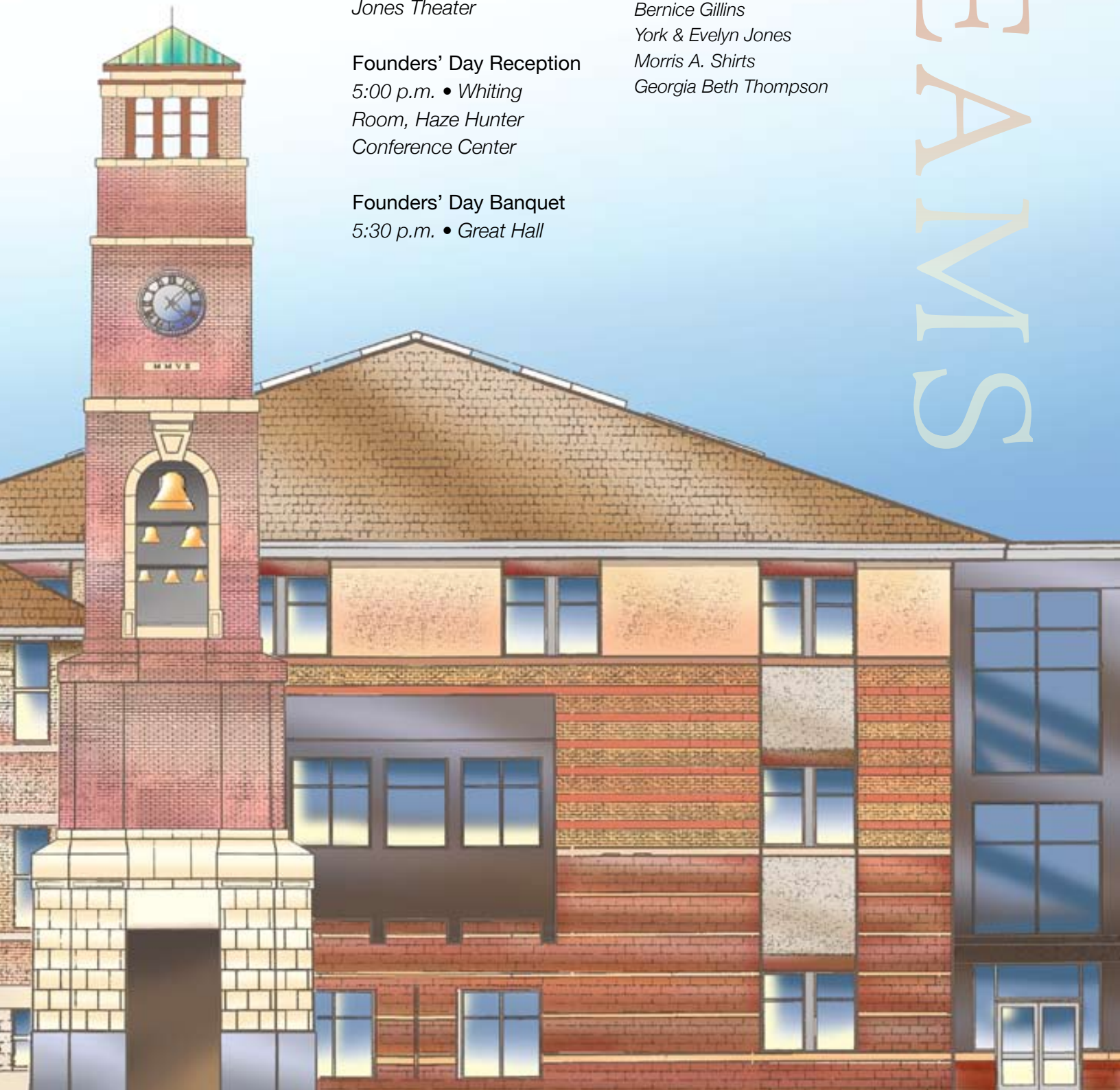

SUU's flagship program gets a new home in the Emma Eccles Jones Teacher Education Building

MONUMENT TO LEARN



An expansive view of SUU and Cedar City is available from the top level of the glass staircase (photo, above).

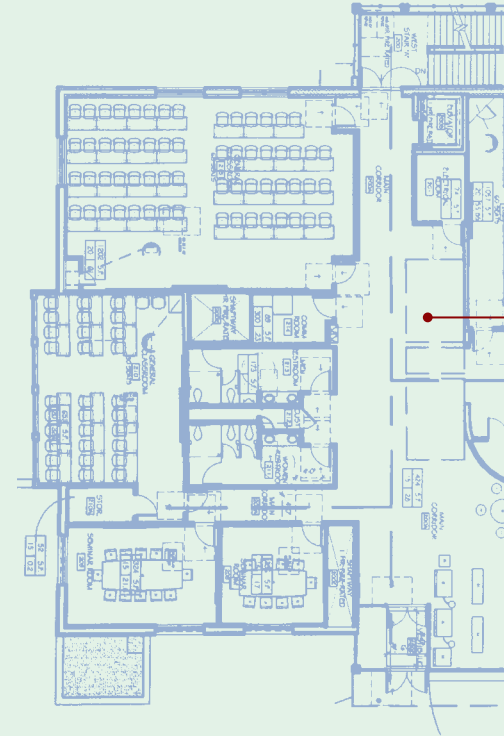

Level two contains the secondary and elementary block classrooms, a literacy lab, seminar rooms, and general classrooms, as well as the early childhood education classroom where these beautiful wood cabinets are found (photo, right).



(left) Level one contains a large lecture hall, the art education classroom, general classrooms, and maintenance/utility spaces.

LEVEL 1

